

**Overview**

- 0 ... 1 mm
- voltage output
- connector M5
- 10 ... 60 °C
- IP 67



Picture similar



**Technical data**

General data		Electrical data	
Mounting type	Quasi-flush	Output signal	0 ... 10 VDC
Measuring distance Sd	0 ... 1 mm	Load resistance	> 1000 Ohm
Resolution	< 0.001 mm (stat.) < 0.005 mm (dynam.)	Short circuit protection	Yes
Repeat accuracy	0.005 mm	Reverse polarity protection	Yes
Linearity error	± 100 µm	Mechanical data	
Temperature drift	± 5 % (Full Scale)	Type	Cylindrical smooth
Electrical data		Housing material	Stainless steel
Response time (factory characteristic)	< 0.5 ms	Dimension	4 mm
Voltage supply range +Vs	15 ... 30 VDC	Housing length	30 mm
Current consumption max. (no load)	15 mA	Connection types	Connector M5
Output circuit	Voltage output	Ambient conditions	
		Operating temperature	10 ... +60 °C
		Protection class	IP 67

# IWRM 04U9701/S05

Inductive distance sensors - subminiature

Article number: 10154686

## Dimension drawing

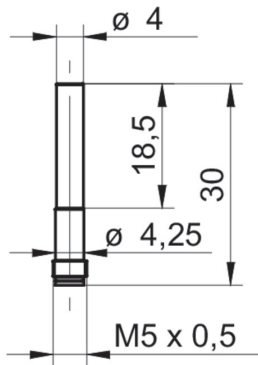

## Connection diagram

