

FSF 025B1007

Glass fiber optic cable

Article number: 11004134

Overview

- Through-beam type
- Actual range up to 160 mm
- Threaded sensing head M4
- Metal jacket 25 cm long
- Operating temperature up to +250 °C
- For rugged fiber optic sensors FVDM 15



Picture similar

Technical data

General data		Mechanical data	
Operating principle	Through-beam type	Width / diameter (head)	4 mm
Actual range Sb	160 mm	Height / length (head)	26 mm
Fiber optic head	Cylindrical threaded	Material (head)	Brass
Operating temperature	-25 ... +250 °C	Thread	M4 x 0.7
Exit angle	60°	Bending radius (fixed)	15 mm
Fiber optics can be shortened to length	No	Bending radius (mobile)	30 mm
Integrated lens	No	Cable jacket diameter	5 mm
Adaptable lens	Yes	Material cable jacket	Brass chromium plated
Infrared light compatibility (1450 nm)	Yes	Fiber cross section	2 mm ²
Smallest object recognizable	0.1 mm	Material (fiber optic cable)	Glass
		Length (fiber optic cable)	25 cm

Dimension drawing

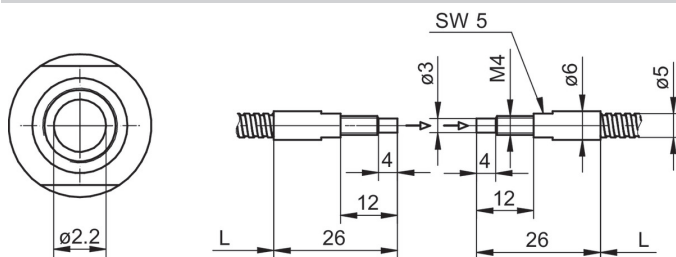

Fiber arrangement

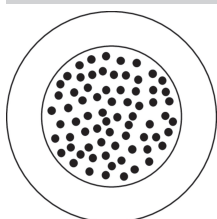

Accessories**Fitting fiber optic sensors**

10234639	FVDM 15N5103
10122368	FVDM 15N5103/S14
10234520	FVDM 15P5103
10239451	FVDM 15P5103/S14
10234519	FVDM 15P5130
10124952	FVDM 15P5130/S14

Mounting accessories

10103230	Replacement cap nut for fiber optics series 15
----------	--

Lenses and components

10119909	Doubling lens M4 increases the actual range (paires)
----------	--